

DOCUMENTS on DEPOSIT



**These documents
should remain available for
public inspection until
27th August 2018**

In the Borough of Maidstone

**THE KENT COUNTY COUNCIL
(VARIOUS ROADS, THE BOROUGH OF MAIDSTONE)
(20MPH, 30MPH, 40MPH, 50MPH SPEED LIMITS AND DERESTRICTED
ROADS) AMENDMENT No.29 ORDER 2018**

Road Traffic Regulation Act 1984

Please return to:

Schemes Planning and Delivery Manager
Kent County Council Highways, Transportation & Waste
Ashford Highway Depot
Javelin Way
Ashford
TN24 8AD



In the Borough of Maidstone

THE KENT COUNTY COUNCIL (VARIOUS ROADS, THE BOROUGH OF MAIDSTONE) (20MPH, 30MPH, 40MPH, 50MPH SPEED LIMITS AND DERESTRICTED ROADS) AMENDMENT No.29 ORDER 2018

Road Traffic Regulation Act 1984

NOTICE is hereby given that the Kent County Council has made the above named Order under Sections 81, 82, 83 and 84 of the Road Traffic Regulation Act 1984, the effect of which would be to: -

1. To introduce a 30mph Speed Limits along Harrietsham in the following roads

ASHFORD ROAD: From a point 113 metres south east of West Street western junction to a point 85 metres east of the junction of Downlands

2. To amend the 40mph Speed Limit in Harrietsham in the following roads

ASHFORD ROAD: From a point 93 metres north-west of the junction of Holm Mill Lane to a point 113 metres south east of the junction with West Street

ASHFORD ROAD: From a point 85 metres east of Downlands for a distance of 400 metres in a eastern direction

A copy of the proposed Order, statement of the Council's reasons for making the proposed Order, a map indicating the location and the effect and a copy of any other Orders which will be amended by the proposed Order may be examined on Mondays to Friday at The Kent County Council, Sessions House, Maidstone, ME14 1XQ and at The Kent County Council, Highway, Transportation & Waste, Ashford Highway Depot, Henwood Industrial Estate, Unit 4 Javelin Way, Ashford, Kent TN24 8AD during normal office hours or viewed online at www.kent.gov.uk/highwaysconsultations

Anyone may, by application to the High Court within 6 weeks of the date of publication of this Notice, challenge the validity of the Orders or of any provision contained in them on the grounds that it is not within the powers conferred by the Road Traffic Regulation Act 1984, or any instrument made thereunder, or that there has been a failure to comply with any statutory requirement to the Orders.

Tim Read

Interim Director
Highways, Transportation & Waste

STATEMENT OF REASONS



In the Borough of Maidstone

THE KENT COUNTY COUNCIL (VARIOUS ROADS, THE BOROUGH OF MAIDSTONE) (20MPH, 30MPH, 40MPH, 50MPH SPEED LIMITS AND DERESTRICTED ROADS) AMENDMENT No.29 ORDER 2018

Road Traffic Regulation Act 1984

STATEMENT OF REASONS

The Kent County Council as traffic authority intends to make the Order referred to above and as shown on the drawing accompanying this document for the following reasons: -

Due to the construction of new developments in Harrietsham it has become necessary to amend the Speed Limits to avoid the danger to persons or other traffic using the road or any other road or for preventing the likelihood of any such danger arising.

Tim Read

Interim Director, Highways, Transportation and Waste
County Hall
Maidstone

THE KENT COUNTY COUNCIL
(VARIOUS ROADS, THE BOROUGH OF MAIDSTONE)
(20MPH, 30MPH, 40MPH, 50MPH SPEED LIMITS AND DERESTRICTED ROADS)
AMENDMENT No.29 ORDER 2018

ROAD TRAFFIC REGULATION ACT 1984

THE KENT COUNTY COUNCIL, acting as local traffic authority and in exercise of its powers under Sections 81, 82, 83 and 84 of the Road Traffic Regulation Act 1984 (hereinafter referred to as the Act of 1984) as amended, and of all other enabling powers and after consultation with the Chief Officer of Police in accordance with Part III of Schedule 9 to the said Act of 1984, hereby makes the following Order.

REVOCATION, MODIFICATION AND AMENDMENTS

1. The "Kent County Council (Various Roads, The Borough of Maidstone) (20MPH, 30MPH, 40MPH, 50MPH Speed Limits and Derestricted Roads) Consolidation Order 2012" ("the Order of 2012") be amended as follows

In the Schedule 40 of the Order of 2012 the following shall be deleted from the Table below.

| Item No | Road Name | Parish | Description |
|---------|--------------|-------------|--|
| 33 | ASHFORD ROAD | HARRIETSHAM | From a point 90 metres east of its junction with Downlands to a point 95 metres west of its junction with Willow Close |

In the Schedule 3 of the Order of 2012 the following shall be added from the Table below.

| Item No | Road Name | Parish | Description |
|---------|--------------|-------------|---|
| 268 | ASHFORD ROAD | HARRIETSHAM | From a point 113 metres south east of West Street western junction to a point 85 metres east of the junction of Downlands |

In the Schedule 4 of the Order of 2012 the following shall be added from the Table below.

| Item No | Road Name | Parish | Description |
|---------|--------------|-------------|---|
| 115 | ASHFORD ROAD | HARRIETSHAM | From a point 93 metres north-west of the junction of Holm Mill Lane to a point 113 metres south east of the junction with West Street |
| 116 | ASHFORD ROAD | HARRIETSHAM | From a point 85 metres east of Downlands for a distance of 400 metres in a eastern direction |

CITATION AND COMMENCEMENT

This Order may be cited as "The Kent County Council (Various Roads, The Borough of Maidstone) (20mph, 30mph, 40mph, 50mph Speed Limits and Derestricted Roads) Amendment No.29 Order 2018" and shall come into operation on the 30th day of July 2018.

GIVEN under the Common Seal of The Kent County Council

This day of 2017

**THE COMMON SEAL OF THE
KENT COUNTY COUNCIL**

**Was hereunto affixed
In the presence of: -**

Authorised signatory

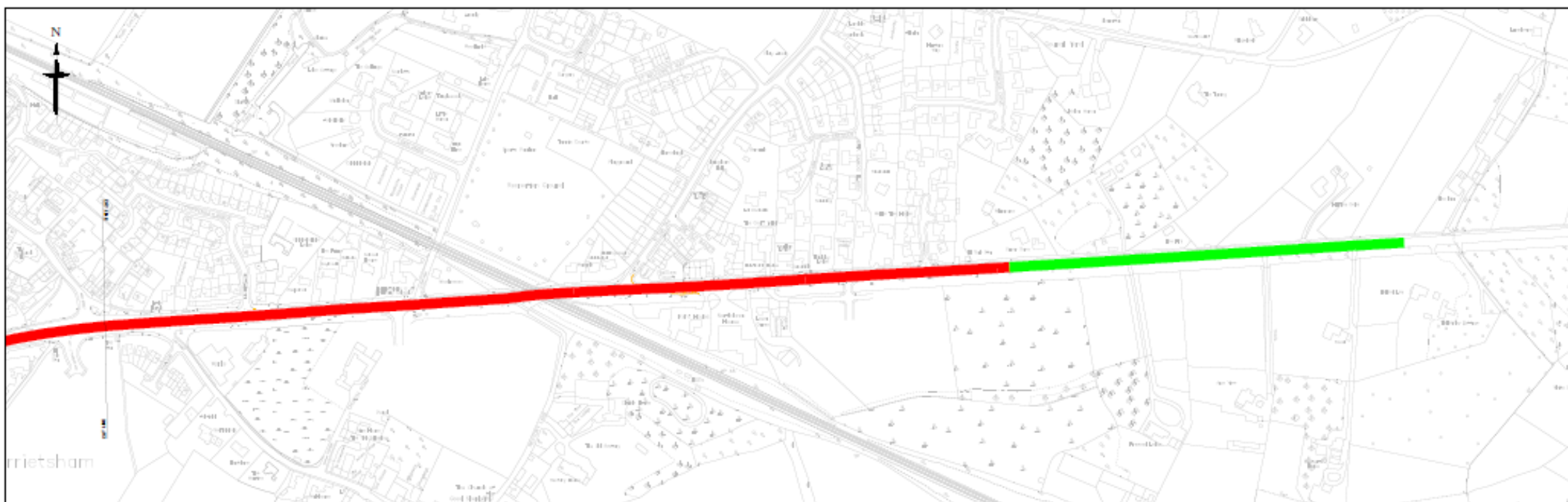
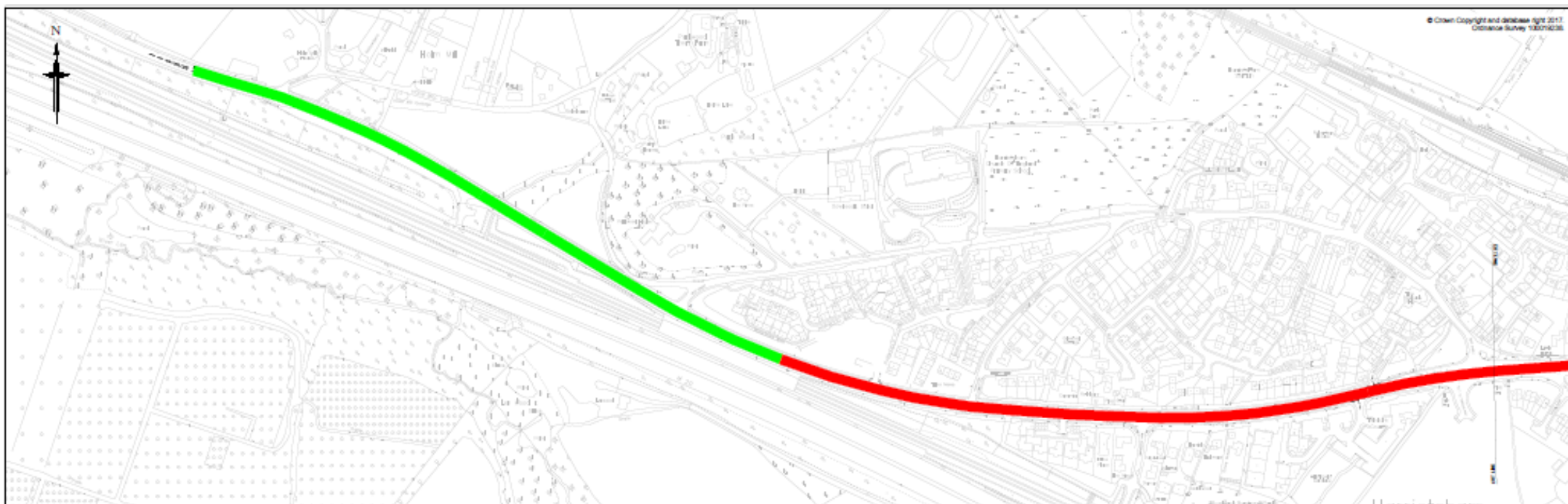

Proposed 30mph Speed Limit
Proposed 40mph Buffer Zone

A20 ASHFORD ROAD, HARRIETSHAM
PROPOSED VILLAGE ENHANCEMENT SCHEME